

# I4

## 4" Line Voltage Housing Non-IC New Construction

### Product Specifications

**Description:**

The I4 recessed down light can be used for either commercial or residential new construction applications. For use in non-insulated ceilings. Must be kept at least 3" away from insulation.

**Lamp:**

50W 20PAR max.

**Socket:**

E26 Medium base socket

**Socket Plate:**

Adjustable socket plate adjusts and locks in position without tools for multiple lamp and trim types.

**Installation:**

Includes adjustable hanger bars (14"-25") with integral nail. Bar hangers can be repositioned 90° without tools. Barhangers can be locked into place with locking screws.

**Junction Box:**

Galvanized steel junction box with 1/2" and romex wiring knockouts, with removable access plates for easy installation.

**Thermal Protector:**

Integral thermal protector protects against improper lamping and insulation proximity.

**Labels:**

- NRTL listed for through-branch wiring and damp locations. (See trim for wet location listing).
- NRTL listed to US and Canadian safety standards.

|                   |              |
|-------------------|--------------|
| <b>Catalog #:</b> | <b>Type:</b> |
| <b>Notes:</b>     |              |

### Dimensions

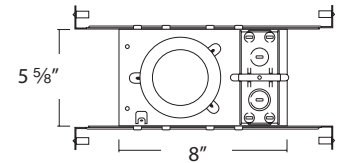
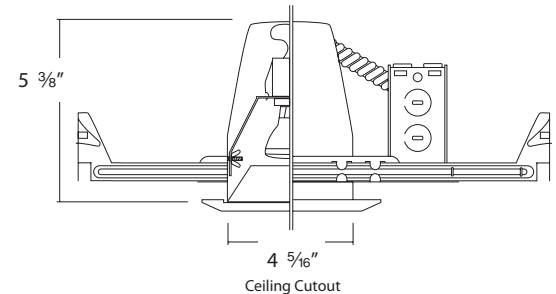

\*Note: Specifications and dimensions subject to change without notice.

2861. E La Palma Ave. • Anaheim, CA 92806 • Phone: 1.800.961.5321 • Fax: 1.800.961.5322 • [www.intenselight.com](http://www.intenselight.com)



**INTENSE**  
LIGHTING  
*Where Creativity and Performance Meet*

|                   |              |
|-------------------|--------------|
| <b>Catalog #:</b> | <b>Type:</b> |
| <b>Notes:</b>     |              |

## 4" Line Voltage Trims

### 4" Down Light Trims

|   | CATALOG # | DESCRIPTION                         | LAMP                  | FINISHES            | TRIM OD |
|---|-----------|-------------------------------------|-----------------------|---------------------|---------|
| ◆    | IC43      | 4" Step Baffle Trim With Metal Ring | R20 / PAR 20 50W Max. | WW, PWW, BW, SN, MO | 5 1/4"  |
|      | IC44      | 4" Deep Step Baffle W/ Metal Ring   | R20 / PAR 20 50W Max. | PWW, PBW, PBB       | 5 1/4"  |
| ◆    | ICR49     | 4" Reflector                        | R20 / PAR 20 50W Max. | WW, CW, BW, SDW     | 5 1/4"  |
|      | ICR43     | 4" Wall Wash With Clear Reflector   | PAR16 50W Max.        | WW, CW              | 5 1/4"  |
|      | IC42      | 4" Wall Wash With Baffle            | PAR16 50W Max.        | W, B                | 5 1/4"  |
|      | ICB48     | 4" Eyeball                          | R20 / PAR 20 50W Max. | W, SN, MO           | 5 1/4"  |
|      | ICA47     | 4" Adjustable Gimbal                | R20 / PAR 20 50W Max. | W, SN, MO           | 5 1/4"  |
| <b>4" Shower Trims</b>  |           |                                     |                       |                     |         |
| ●  | ICS43     | 4" Shower W/ Fresnel Lens           | R20 / PAR20 50W Max.  | W, SN, MO           | 5 1/4"  |
| ●  | ICS42     | 4" Shower W/ Albalite Lens          | R20 / PAR20 50W Max.  | W, SN, MO           | 5 1/4"  |
| ●  | ICS45     | 4" Shower W/ Sand Blasted Lens      | R20 / PAR20 50W Max.  | W, SN, MO           | 5 1/4"  |
| ●  | ICS47     | 4" Shower W/ Frosted Spot Lens      | R20 / PAR20 50W Max.  | W, SN, MO           | 5 1/4"  |

**Key Code:**

● : Wet Location Listed ◆ : Optional metal trim ring. Specify MW (metal white), B (metal black), C (clear), MO (mocha), SN (satin nickel)

Special order trim ring Specify G (gold), AN (antique nickel), AC (antique copper), CAP (cappuccino)

Finish: W (white), B (black), SN (satin nickel), MO (mocha), PW (phenolic white). Reflector Finish: C (clear), W (white), B (black), G (gold), SD (semi diffuse)

\*Note: Specifications and dimensions subject to change without notice.

