

ITH81 - Tangent T6

CMH T6 G12 Base

Catalog #:	Type:
Notes:	

Product Specifications

Lamp/Socket:

39/70W T6 CMH G12 Base

Reflector Optic:

-**FL24** (24° narrow flood), -**FL45** (45° flood), -**FL60** (60° wide flood)

Features:

- Slim profile
- Architectural design
- Electronic Ballast
- Die-cast aluminum construction
- Lockable aiming
- Manual on/off power switch
- Compatible with Professional Series track system

Track Compatibility:

Single/two circuit positive contact is present to "down" position at factory, but may be raised to the higher position to install onto the second circuit.

Electronic Ballast:

5 Years ballast manufacture warranty
End of lamp life protection
High Power Factor.
Open Circuit Voltage 300V max.
Sound Rated A
Max. case temp +80°C
Ignition Voltage 4.0KV max.
THD < 5%
PF > 98%
Outdoor Type 1

Professional Series Option:

Track fixture is compatible with Intense Two Circuit / Two Neutral Professional Track series. Track adapter is factory installed on fixture. Must specify -27 for 277V.

Two Circuit / Two Neutral 120V

The independent neutrals guarantee that the two circuits are completely isolated. Independent neutrals also offer twice the power handling capacity of ordinary common neutral track.

Two Circuit / Two Neutral 277V

The Intense Professional Series 2-cct/2-neutral 277V track system is well suited for larger retail and institutional applications where a number of metal halide fixtures are used. The 277V system offers twice the capacity of ordinary 120V track allowing for substantially longer runs with more fixtures between feed points. This translates into enhanced aesthetics and reduced installation costs.

Listing:

NRTL Listed for dry locations.

Dimensions

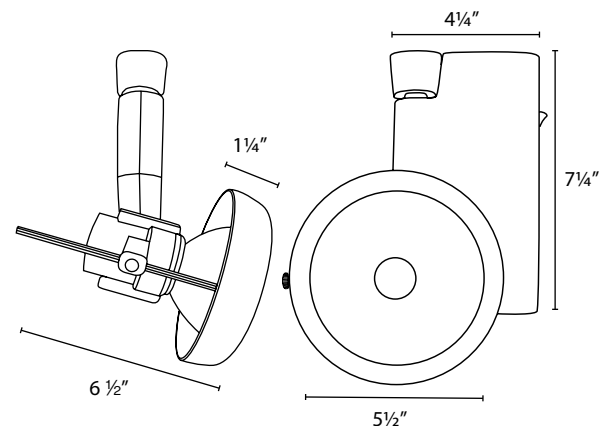

Ordering Matrix

ITH81

Series

Wattage/Lamp

039 39W T6 G12
070 70W T6 G12

Finish

W white
B black
SN silver

Reflector

-**FL24** 24° narrow flood
-**FL45** 45° flood
-**FL60** 60° wide flood

Options

-**PS** 120V pro series
-**PS-27** 277V pro series

*Note: Specifications and dimensions subject to change without notice.

2861. E La Palma Ave. • Anaheim, CA 92806 • Phone: 1.800.961.5321 • Fax: 1.800.961.5322 • www.intenselighting.com

