

### ⚠ WARNING

Risk of electrical shock. Disconnect power before servicing or installing luminaire.

### ⚠ WARNING

Risk of injury or damage. Luminaire will fail if not installed properly. Follow installation instructions.

### ⚠ WARNING

Risk of injury. Wear safety glasses and gloves during installation and servicing. Allow ample time to cool before handling.

### IMPORTANT SAFETY INSTRUCTIONS

- Read all installation instructions before installing. It is important to save these instructions.
- This product must be installed in accordance with the applicable installation code by a person familiar with construction and operation of the product and the hazards involved.
- Product must be installed by a qualified person in a manner consistent with its intended use and in compliance with the National Electrical Code, Canadian Electrical Code and all Local and Provincial Codes.
- To reduce the risk of fire or injury to persons: Turn off/unplug and allow to cool before servicing. Do not touch hot lens, guard or enclosure. Do not operate the luminaire fitting with a missing or damaged shield.
- Follow product label information and instructions.
- Before wiring and during servicing, turn off power at fuse or circuit breaker before service.
- The use of accessory equipment not recommended by the manufacturer or installed contrary to the instructions may cause an unsafe condition. The use of damaged components may cause an unsafe condition and void product warranty.
- Never operate the fixture with missing or damaged lens. Lens must be cleaned on a regular basis.
- All gaskets, o-rings and sealing services must be kept clean during installation and service. Failure to do this may cause an unsafe condition and void product warranty.
- This device complies with Part 15 of the FCC Rules. Operation is subject to the following two conditions: (1) this device may not cause harmful interference, and (2) this device must accept any interference received, including interference that may cause undesired operation.

### FIXTURE INSTALLATION

1. Mount fixture onto suitable enclosure (supplied by others).
2. Secure 1/2" NPS stem to mounting option. Secure with provided locknut if applicable (Fig. 1).
3. Make connections from primary branch circuit wire to fixture leads using silicone filled wire connectors (supplied by others). Connect ground to ground wire on fixture (Fig. 2 & 3).
4. Use provided allen wrench to slightly loosen stainless steel socket head cap screw at knuckle for aiming. Tighten to secure when desired aiming is achieved (Fig. 4 & 5).

### TO CHANGE FILTER MEDIA OR REPLACE OPTICS

1. Loosen set screw and rotate cap a quarter turn to remove (Fig. 6).
2. If media is present, carefully remove retention clip (Fig. 7). Place desired media (up to two) securely in the cap against clear lens. Replace retention clip and ensure media is snugly against clear lens.
3. Remove retention clip on the housing that secures optic (Fig. 8). Carefully lift optic from housing (a small regular screwdriver may be needed).
4. With original optic removed, place desired optic in the housing. (Note: Take care to align the optic around the LED) If the optic presses against the diodes it can damage the LED and void the warranty. Replace retention clip on top of optic and replace cap. Secure set screw along with small gasket. Examine gasket to ensure a secure fit.

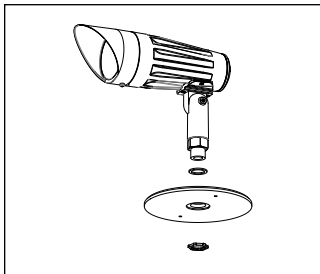

Figure 1

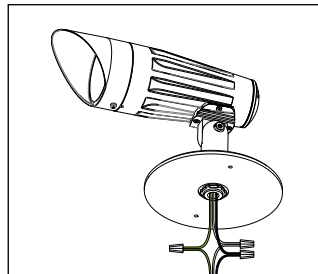

Figure 2

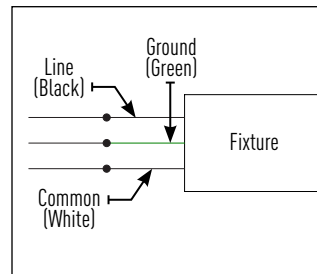

Figure 3

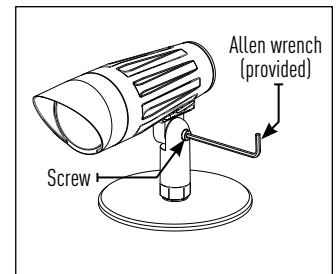

Figure 4

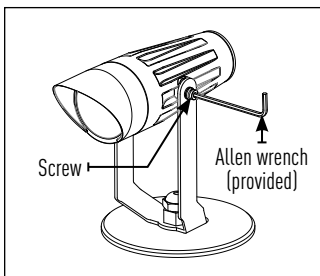

Figure 5

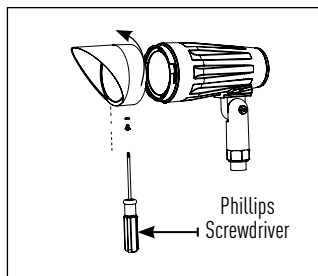

Figure 6

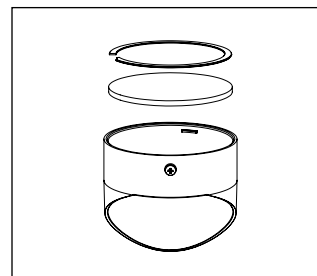

Figure 7

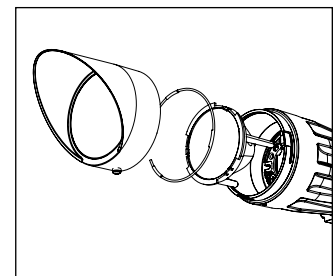

Figure 8